



67 Consul Road Narraweena NSW

2  1  2 

Ocean and District Views - Renovate or Detonate!

Offered for the first time in over 60 years, this location promises an enviable lifestyle opportunity.

At the crest of a hill in a desirable cul-de-sac location, you will find this massive 930 sqm (approx.) block of land providing both Ocean and District views.

The house itself is in original condition, and will attract those who are keen to build their own dream home or are after a renovators delight!

The property also features a large double lock up garage. Close to transport, shops and schools.

[For full version visit the website](https://www.cjhills.com.au)

Type : House
Price : \$ 885,000
Land Size : 930 sqm
View : <https://www.cjhills.com.au/sale/nsw/northern-beaches/narraweena/residential/house/6181546>



Colin Hills
02 9918 3864

67 Consul Road, Narraweena

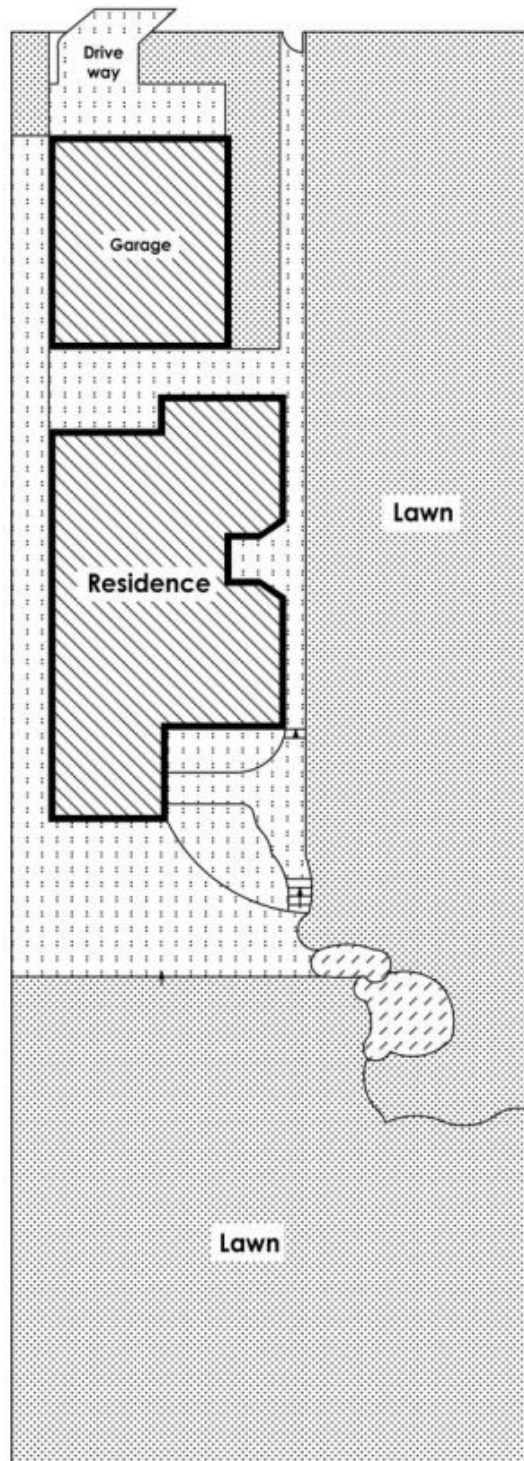
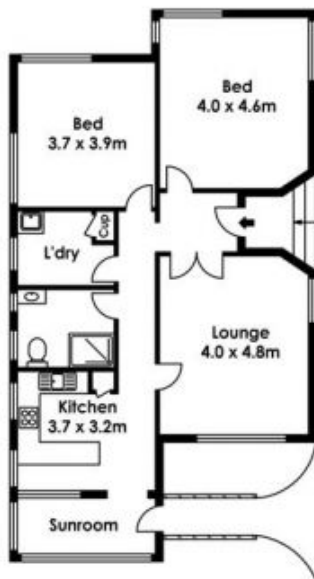
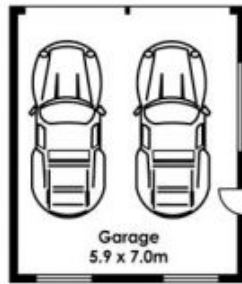

Plans are for presentation purposes only and are not part of any legal document or title and should not be used as a sole reference. Interested parties should make their own enquires using other sources. Measurements are approximates. We do not guarantee or give any warranty as to the accuracy provided. Interested parties must rely on their own enquiries.