

290 Mowbray Road Artarmon NSW

4  2  2 

CHARMING, SOPHISTICATED & CONVENIENT

This stunning single level federation family home boasts 4 double bedrooms. Recently updated with newly polished floorboards and fresh paint, providing the perfect blend of traditional character and sophisticated styling. This double brick home and large low maintenance child-friendly backyard is private and surprisingly quiet with driveway/garage access from adjoining cul-de-sac Muttama Road. Set on 823m2 approx. block of land in an exceptionally convenient location within the catchment of excellent schools and near to the cosmopolitan Shopping District of Chatswood and both bus and rail transport links.

Features include:

- 4 generous bedrooms
- Large living area plus separate dining
- High ornate ceilings and picture rails

Price : \$ 1,520,000

Land Size : 823 sqm

View : <https://www.cjhills.com.au/sale/nsw/north-shore-lower/artarmon/residential/house/6181557>



Colin Hills
02 9918 3864

290 Mowbray Road, Artarmon

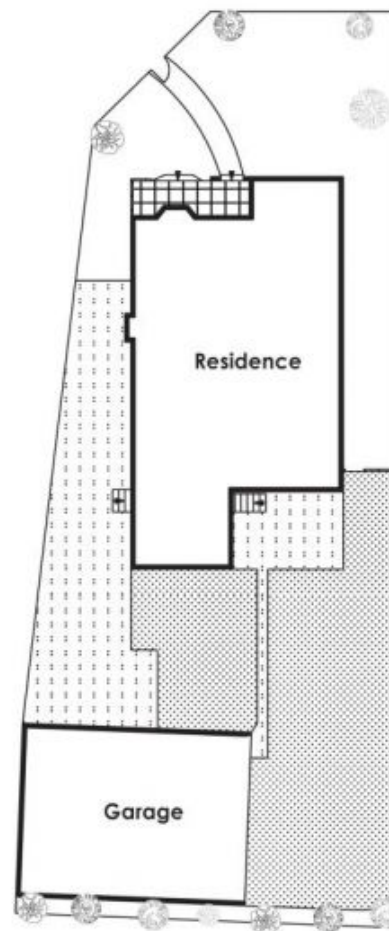
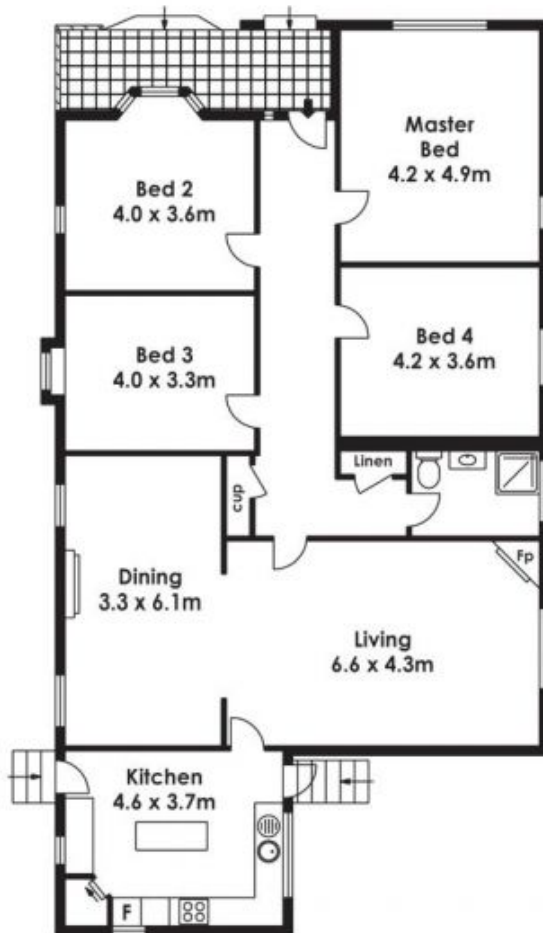
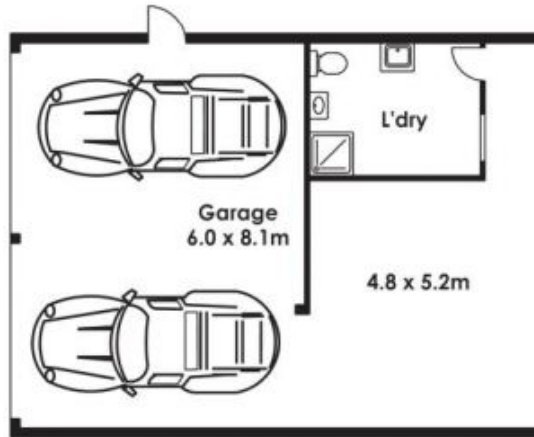

Plans are for presentation purposes only and are not part of any legal document or title and should not be used as a sole reference. Interested parties should make their own enquires using other sources. Measurements are approximates. We do not guarantee or give any warranty as to the accuracy provided. Interested parties must rely on their own enquiries.