





280 Mowbray Road Artarmon NSW

5  3  1 

BEAUTIFULLY RESTORED AND EXTENDED

This stunning double brick early federation home (circa 1902) has been fully restored and extended to maintain all its original features yet enhanced with the finest contemporary styling, fixtures and fittings. Reflecting all that is luxurious and elegant this immaculate home is private, optimising space and light, it holds immense appeal for those seeking an impressive family home. Offering generous open plan living spaces, the ultimate parents retreat, superb outdoor entertaining, private level lawns, saltwater swimming pool and city views, all within walking distance to conveniences.

Features include:

- Flexible floor plan with both formal and casual living spaces, home office or 5th bedroom with separate entrance
- Master Suite with separate dressing room that every

Land Size : 875 sqm

View : <https://www.cjhills.com.au/sale/nsw/north-shore-lower/artarmon/residential/house/6181566>



Colin Hills
02 9918 3864

280 Mowbray Road, Artarmon

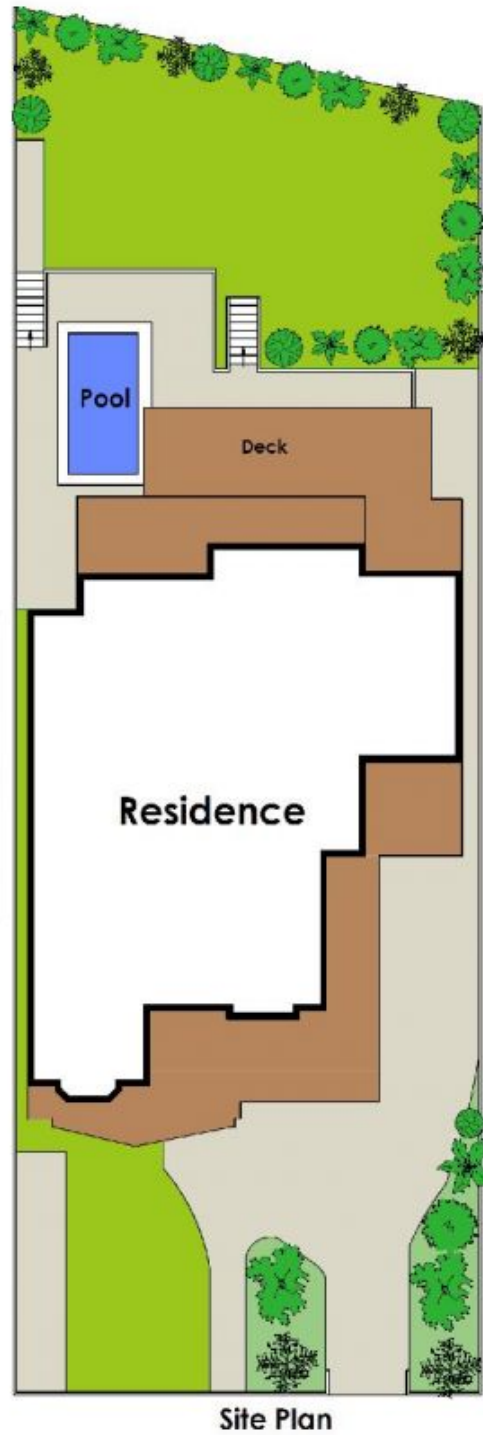

Plans are for presentation purposes only and are not part of any legal document or title and should not be used as a sole reference. Interested parties should make their own enquires using other sources. Measurements are approximate. We do not guarantee or give any warranty as to the accuracy provided. Interested parties must rely on their own enquiries.